



भारतीय राष्ट्रीय राजमार्ग प्राधिकरण

(सडक परिवहन और राजमार्ग मंत्रालय, भारत सरकार)

National Highways Authority of India

(Ministry of Road, Transport & Highway)

परियोजना कार्यान्वयन, इकाई, सोलापूर (महाराष्ट्र)

Project Implementation Unit, Solapur (Maharashtra)

कार्यालय/Office :

प्लॉट नं. ई-२, जय जलाराम नगर, शिवदारे कॉलेजच्या मागे,

जुळे सोलापूर, सोलापूर - ४१३००४ (महाराष्ट्र)

Plot No. E-2, Jai Jalaram Nagar, Behind Shivdare College,

Jule Solapur, Solapur - 413 004. Tel/Fax - 0217 2303379

ई-मेल/Email : solapur@nhai.org; piusolapur@gmail.com

No.: NHAI/PIU/SLP/PS-II/US/OFC/13022/2017-18/1/2598

Date: 25/09/2020.

INVITATION OF PUBLIC COMMENTS

Sub: Four laning of Pune - Solapur section of NH-9 from Km.144/400 to Km. 249/000 in the State of Maharashtra under NHDP Phase III on DBFOT Basis - **Permission for Overhead crossing of EHV 132 KV LILO on Mohol (Chincholi Kati) to 132 KV Mohol TSS on Solapur-Pune NH No. 65 at Village-Kolegaon, Tal. Mohol between KM 221.600 and 221.627 - Reg.**

Sir,

1. The Executive Engineer, EHV Proj. Div- III, Solapur has proposed erection for Overhead crossing of EHV 132 KV LILO on Mohol (Chincholi Kati) to 132 KV Mohol TSS on Solapur-Pune NH No. 65 at Village-Kolegaon, Tal. Mohol between KM 221.600 and 221.627 on Pune Solapur section of NH-65 & Dist. Solapur.
2. As per the guidelines, issued by the Ministry vide OM No. RW /NH-33044/29/2015/ S&R(R) dated 22.11.2016, the application shall be put out in the public domain for 30 days for seeking claims and objections (on grounds of public inconvenience, safety and general public interest).
3. In view of the above, comments of the public on the above application is invited to the below mentioned address, which should reach by this office within 30 days from the date of publication beyond which no comments shall be entertained.

The Project Director

National Highways Authority of India
Project Implementation Unit, Solapur
Plot No. E-2, Jalaram Nagar,
Solapur, Maharashtra,
Pin - 413004

Thanking you,

भवदीय

परियोजना निदेशक

भा.रा.रा.प्रा. प.का.ई, सोलापूर

Copy to:-

- i. CGM (Tech) RO Mumbai for information please,
- ii. Executive Engineer, EHV Proj. Div- III, Solapur - for information.
- iii. M/s. K&J Projects Pvt. Ltd, Solapur - for information.
- iv. M/s. PSRDCL, Solapur for information.
- v. Master file.



M. S. E. T. Co. Ltd, 132 kV, Navives S/Stn. Premises Old mill
Compound, Solapur-413001

E-Mail: ee6630@mahatransco.in
eeconst3spl@gmail.com

PHONE NO. (0217) 2320181
FAX NO. (0217) 2320141

No. EE/EHV/PD-III/Solapur /

1000088

Date: **18 JAN 2020**

To,
PROJECT DIRECTOR,
NHAI, Plot No. 80,
Old Santosh Nagar, Jule Solapur,
Near Devika Gas Agency,
Solapur- 413 003.

Sub :- Proposal for Overhead crossing of 132 K.V. LILO on Mohol (Chincholi) to 132 KV Mohol TSS of RVNL Transmission line for Rail Electrification on Pune-Solapur National Highway No. 65 at Village-Kolegaon, Tal- Mohol between KM stone 221/600 and 221/627.

-- For NOC thereof.

Ref :- 1) This office letter no-1373 dt-02/12/2019
2) NHAI/PIU/SLP/PS-II/IE/13027/18/7972 dt-06/01/2020

Dear Sir,

With reference to above subject, this office has submitted a proposal for overhead crossing of 132 K.V. LILO on Mohol-Chincholikati to 132 KV Mohol TSS of RVNL Transmission line for Rail Electrification on Pune-Solapur National Highway No. 65 vide letter under ref(1). Some corrections in this regard are received from your office vide letter under ref No(2).

The corrections were noted and duly corrected which are as follows

1. The checklist is corrected as per site requirement.
2. The undertakings attached are duly printed on stamp paper.
3. Drawing showing all the details is attached.

The said line is crossing Overhead on Pune-Solapur National Highway No. 65 at village Kolegaon, Tal -Mohol, Dist -Solapur between Kilometer stone 221/600 and 221/627 with crossing span of 196 mtr.

The corrected National Highway crossing proposal is duly filled in and signed along with crossing plan, drawing showing the details and with necessary documents in 03 sets.

As the above work is being taken up shortly and is to be completed on priority, it is requested your good self to convey your approval for the above proposal at the earliest please.

Submitted for your information & needful action please.

Thanking You,

Yours faithfully,

(S.K Gade)

Executive Engineer
EHV Proj. Div-III
Solapur

Encl: -

- 1) License Deed for use of NH Land
- 2) Undertaking
- 3) Maharashtra Govt. Order
- 4) Drawing showing details - (3 Nos).

Copy s.w.r.s to:-
Copy to :-

- 1) The S.E. EHV Proj. Circle, Pune.
- 1) Addl. Executive Engineer, EHV, S&I, S/Dn-III, Solapur.
- 2) Addl. Ex Engineer, EHV ssth. Proj S/Dn. Solapur.

C-53

INDEX

MAHARASHTRA STATE ELECTRICITY TRANSMISSION COMPANY LIMITED

Proposal for Overhead crossing of 132 K.V. LILO on Mohol (Chincholi) to 132 KV Mohol TSS of RVNL Transmission line for Rail Electrification on Pune-Solapur National Highway No. 65 at Village-Kolegaon, Tal- Mohol between KM stone 221/600 and 221/627.

Sr. No	SUBJECT	Page No	
		From	To
1	Covering letter	1	-
2	Check List	2	7
3	License Deed for use of National Highway Land	8	14
4	Undertaking	15	32
5	Joint Inspection Report	33	34
7	Maharashtra Govt. Order	35	37
8	Drawing showing the details (3 copies)	38	-

Check list

Relevant circulars/ codes :-

MINISTRY Circular No. NH-III/P/20/77 dated 08.04.1982.

Indian Electricity Act 191

Indian Electricity 1956

IRC : 32-1969

IS : 5613-1976 Part I to IV

For getting approval for laying of overhead electrical transmission line across the NH - 65 vested with NHAI.

Sr. No.	Item	Information/Status	Remark
1	General Information	132 KV Mohol TSS D/C line across NH 65 from Km 221/600 to 221/627 of Crossing in the state of Maharashtra National Highway Authority of India land. For this purpose, power line will be laid by Overhead crossing Method.	
1.1	Name and Address of the applicant	Maharashtra State Electricity Transmission Co. Ltd. EF/EHV/Project Division-III, Solapur. 132 KV Navives S/S. Old mill Compound premises. Solapur - 413006.	
1.2	National Highway Number	NH 65	
1.3	State	Maharashtra	
1.4	Location	Village- Kolegaon, Tal-Mohol, Dist-Solapur.	
1.5	Type of electric including carrying voltage detail and purpose	132 KV D/C supply for Mohol Traction substation of Rail Vikas Nigam Ltd.	
1.6	(Chainage in Km)	Between Kms 221/600 to 221/627.	
1.7	Length in Meters	196.00 Mtr	
1.8	Width of available ROW	60 Mtrs.	
	A) Left side from center line towards increasing chainage/Km direction.	22.79 Mtrs	
	B) Right side from center line towards Increasing chainage/Km direction.	37.21 Mtrs.	

1.9	<p>Proposal to overhead power line of 132 KV</p> <p>A) Left side from center line towards increasing chainage/Km direction.</p> <p>B) Right side from center line towards Increasing chainage/Km direction.</p> <p>C) Erection of Electrical line along the NH - 65</p>	<p>221/600 to 221/627 Km</p> <p>13.50 Mtr</p> <p>13.50 Mtr</p> <p>Not Applicable.</p>	
1.10	<p>Proposal to acquire land</p> <p>A) Left side from center line.</p> <p>B) Right side from center line.</p>	<p>Not Applicable</p> <p>No</p> <p>No</p>	
1.11	<p>Whether proposal is.</p> <p>A) In the same side where Land is not to be acquired.</p> <p>B) Crossing the National Highway.</p> <p>If not, then where to lay the overhead power line.</p>	<p>Yes</p> <p>Yes</p>	
1.12	Details of already laid services (Overhead Telecommunication line, overhead electric line etc. if any, along the proposed route/proposed crossing.)	Not Applicable.	
1.13	Number of lanes (2/4/6/8 Lanes) existing	4 Lane.	
1.14	Proposed number of lanes (2 Lane with Paved shoulders 4/6/8 Lanes)		
1.15	<p>Service road existing or not. If yes then which side</p> <p>A. Left side from center line.</p> <p>B. Right side from center line.</p>	<p>Not existing</p> <p>Not Applicable.</p> <p>Not Applicable.</p>	
1.16	<p>Proposed service road</p> <p>A. Left side from center line.</p> <p>B. Right side from center line.</p>	<p>Not Applicable.</p> <p>Not Applicable.</p>	
1.17	Whether proposal to lay overhead line is after the service road or between the service road and main carriageway or crossing for approval/rejection based on the Ministry circulars and relevant codes mentioned above.	Not Applicable.	
1.18	Ministry circulars and relevant codes mentioned above.		
1.19	<p>Crossing of road involved</p> <p>a) Crossing angle for NH and provide length along the highway</p> <p>b) Structure (Tower, pole and for HT line only tension tower) for crossing shall not be too near the existing structure on the National Highway. (The minimum distance being 15 mt.)</p> <p>I. Type of existing / proposed structure of NH.</p> <p>II. What is the distance of tower pole and tension tower laying from the existing/ proposed structure for NH.</p>	<p>Yes</p> <p>79°02'57" and 196 m</p> <p>D) Nil</p> <p>II) Distances are 107.55m from road edge at RHS to Loc.9 and 65.58m from road edge at LHS to Loc.10</p>	

	c) The overhead lines and their supporting poles/ towers should ordinarily be placed at the extreme edge of the road land boundary. In any case these shall be at least 10 meter away from edge of existing shoulder of extreme traffic lane. Where the existing road away is narrower then the minimum according or standard or where the widening is proposed for any reason the lateral clearance shall be reckoned with respect to ultimate road way. What is the horizontal clearance from the extreme edge of the road land boundary ?	Not Applicable Horizontal clearance are 91.42m and 44.58m from Tower no 9 and 10 respectively.	
	d) Overhead lines and their supporting poles / towers should originally be placed at the minimum distance of 5.0 m from the nearest line of avenue trees. What is the horizontal clearance from the nearest line of avenue tree?	Yes Horizontal clearance are 91.42m and 44.58m from Tower no 9 and 10 respectively	
	e) In mountain/ hilly terrain the overhead line should be erected preferably only the valley side as far as practicable. In hilly region level of ground at the suitable distance below the outer conductor on either side from the central line is also to be noted and marked in profile so as to ensure required ground clearance underneath conductor and site clearance is swing conditions. Is the proposal in hilly area?	Plain terrain	
	f) The horizontal clearance in respect of poles erected from the purpose of street lightning in urban situation shall be as under.	Not Applicable	
	i) For roads with raised kerbs	Minimum 300 mm from the edge of nearest kerb preferably 600 mm	Not Applicable
	ii) For roads with raised kerbs	At least 1.5m from the edge of the carriageway subject to minimum 5.0m from center line carriageway	Not Applicable
	g) The pylons of HT lines along crossing the road shall be located outside the NH land.	Not Applicable	
	h) For crossing the line of same voltage or low voltage, suspension/tension tower with suitable extension shall be used.	Not Applicable	
	I) The vertical clearance of the overhead lines crossing the road shall be reckoned from the top of crown of the road taking into account the anticipated final top level due to figure raising of road level strengthening of pavement ,etc. The actual ground clearance of high tension line for voltage above 650 V varies depending upon the voltage transmitted and these are stipulated in Indian Standard codes IS 56130-1976 Part I to IV and Indian electricity rules 1956 as under	14.42 mtrs (As per drawing enclosed). Actual ground clearance shall be measured after execution of work with NHAI Authority	
2	Affidavit / undertaking to be obtained (to be furnished by the applicant)	Yes	
2.1	Not to Damage to other utility, If damaged then to pay the losses either to NHAI or to the concerned agency.	Yes enclosed	

2.2	Undertaking for Renewal of Bank Guarantee	Yes enclosed	
2.3	Confirming all standard condition laid down in ministry circular no NH-III/P/20/77 dated 08.04.1982 Indian Electricity Act 1910 of Indian Electricity rules 1956 IRC:32-1969, IS:5613-1976 part I to IV of NHAI.	Yes enclosed	
2.4	Shifting of overhead power line at their own costs and when required by (NHAI).	Yes enclosed	
2.5	Shifting of overhead power line at their own costs and when required due to 4/6 laning/ widening of NH.	Yes enclosed	
2.6	Indemnity against all damages and claims whatsoever kind that may to be NHAI or to any third party in the row during installation operation and maintenance.	Yes enclosed	
2.7	Traffic movement during laying of power line to be managed by the applicant.	Yes enclosed	
2.8	If any claim is raised by the Concessionaire then the same has to be paid by the applicant.	Yes enclosed	
2.9	Prior approval of NHAI shall be obtained before undertaking any work of installation shifting or repairs or alteration to the showing of EHV power line located in the National Highway right of way.	Yes enclosed	
2.10	Expenditure ,if any, incurred by / electric department of repairing any damage caused to the National Highway by the laying, maintenance or shifting of the EHV power line located in the National Highway right of way.	Yes enclosed	
2.11	If NHAI considers it necessary in future to move The EHV power line for any work of improvement or repairs to the road, it will be carried out as desired by NHAI at the cost of the agency owing the power line within reasonable time (not exceeding 60 days) of the intimation given.	Yes enclosed	
2.12	Certificate from the applicant in the following format. 1) Laying of EHV power line will not have any deleterious effects on any of bridge components & roadway safety for traffic. 2) For 6 laning "We do undertake that we will relocate service road/approach road/utilities at our own cost not with standing the permission granted with in such time as well as stipulated by NHAI" for future 6 laning or any other development.	Yes enclosed	
2.13	The transmission line installation shall be carried out by trained and experienced personal and supervised by technically qualified persons competent to undertake such works.	Yes enclosed	
2.14	The applicant ensures the safety of the highway traffic against the hazard of the high voltage lines during installation operations and maintenance.	Yes enclosed	

2.15	Undertake the compliance with Indian Electricity rules and other authorities regulations all overhead lines shall comply with the requirement of the Indian Electricity act and rules made their under and regulation or specification laid down by NHAI.	Yes enclosed	
3	Other documents and drawing to be furnished by the applicants.		
3.1	Methodology for laying of overhead electric line.	Yes	
3.2	Draft license agreement.	Yes enclosed	
3.3	Performance Bank Guarantee in favor of NHAI has to be obtained @ Rs. 100/- per running meter (parallel to NH) and Rs. 1,00,000/- per crossing of NH, for a period of one year initially (extendable if required till satisfactory completion of work) as a security for ensuring making good the area, clearing debris/loose earth, etc. produced in the right-of-way. No payment shall be payable by the NHAI to the licensee for clearing debris/loose earth.	B.G shall be submitted as soon as permission obtained from NHAI	
3.4	Strip plan/route plan showing power line, chain age, width of ROW, Distance of proposed structure (tower pole and for HT line only tension towers) from the edge of ROW, important milestone, intersections, cross drainage work, any other structures existing or proposed etc.	Yes	
4	Certificate from Project Director		
4.1	Certificate for confirming that the proposal has been examined with respect to the structures and development work considered at this location and compliance of the standard conditions issued vide ministry circular no NS-III/P/20/77 dated 08.04.1982 Indian Electricity Act 1910, Indian Electricity rules 1956, IRC:32,IS-5613-1976 part I to IV and NHAI's guidelines.	Yes	
4.2	Certificate from PD in the following format: (i) "It is certified that any other location of the EHV power line would be extremely difficult and unreasonable costly and the installation of EHV power line within ROW will not adversely affects the design, stability and traffic safety of the highway nor the likely future improvement such as widening of the carriageway, easing of kerb etc." (ii) For 6-laning:- a) Where feasibility is available "I do certify that there will be no hindrance to proposed six-laning based on the feasibility report considering proposed structures at the said location." b) In case feasibility report is not available "I do certify that sufficient ROW is available at site for accommodation of six-laning."	Not Applicable	
5.	If NH section proposed to be taken up by NHAI on BOT basis a clause is to be inserted in the agreement. "The permitted Highway on which licenses has been granted the right to lay EHV power line has also been granted as a right of way to the concessionaire under the concession agreement for up gradation of (Solapur	Not Applicable	

	Mohol. section from 221/600 Km. to 221/627 Kms. of NH No. 65 on Build, Operate and transfer Basis) and there fore, the licensee shall honour the same.		
6.	Who will supervise the work of laying of EHV power line?	Additional Ex. Engineer, MSETCL, EHV, Sub-Station Projects, S/Dn., Solapur.	
7	Who will sign the agreement on behalf of the overhead electric power line agency?	Executive Engineer, MSETCL, EHV, Project Division-III, Solapur - 413006.	
8.	Who will ensure that the defects in road portion after laying of EHV power line are corrected and if not corrected then what action will be taken?	Additional Ex. Engineer, MSETCL, EHV, Sub-Station Projects, S/Dn., Solapur.	
9.	Who will pay the claims for damages done/ disruption in working of concessionaire if asked by the concessionaire?	Executive Engineer, MSETCL, EHV, Project Division-III, Solapur - 413006.	
10.	A certificate from PD that he will enter the proposed permission in the register of records of the permissions in the prescribed proforma (copy enclosed) issued vide ministry circular No. RW/NH/33044/17/2000/S&R dated 23/07/2003.	NI/1	
11.	If any previous approval for laying of overhead EHV line, then photocopy of register of records of permissions accord as Maintained by PD (as per Ministry Circular No. RW/NH/ 33044/17/2000/S&R dated 23/07/2003)		

Executive Engineer
 EHV, Project Div. III,
 M.S.E.T.Co.Ltd., Solapur.



महाराष्ट्र MAHARASHTRA

© 2019 ©

VW 558 05

मालापूर अ. क. १३११३ दि. १६/१/२०२०
 सौ. / श्री. *[Signature]* या जनरल स्टॅम्प
 पांजी रुपये या *[Signature]*
 मागितलेले रकम हा रुपये या *[Signature]*
 स्टॅम्प व भारतीय रुपये या *[Signature]*
 या कारणासाठी स्टॅम्प दिला.



श्री. बलभिम रामचंद्र आयवळे
 मुद्रांक विक्रेता परवाना क्र. १०९/२०००
 रा. ४००/७, बेगम पेठ, सोलापूर.
 पो. नं. १४२०७८०५७५ कोड नं. २५९९००४

AGREEMENT REGARDING GRANTING OF RIGHT OF WAY PERMISSION FOR LAYING UTILITY SERVICES ON NATIONAL HIGHWAYS

Agreement to lay Overhead Electrical Transmission Line (132 KV Trans Line for Mohol
 ISS of RVNL for Rail Electrification) across Pune-Solapur section of NH-65 from Km
 221/600 to 221/627

This Agreement made on 17th day of January Month of year 2020 between National
 Highway Authority of India acting in his executive capacity through
 herein after referred to as the "Authority" which expression shall unless excluded by or
 repugnant to the context, include his successors in office and assigns) on the one part; and
 MAHARASHTRA STATE ELECTRICITY TRANSMISSION COMPANY LIMITED (A Govt. Of
 Maharashtra Enterprise), a company registered under the Companies Act, 1956 and having
 its Registered Office at 132 KV, Navives S/Stn., Old mill compound premises, Solapur - 413
 001 (Herein after called the 'licensee') which expression shall, unless excluded by or
 repugnant to the context, include his successors/ their successors/administrator assignees
 on the second part.

Whereas the Authority is responsible, inter-alia, for development and maintenance of lands in Km 221/600 to 221/627 of NH-65 ROW.

Whereas the Licensee proposes to lay Overhead Electrical Power Transmission Line (**132 KV Trans Line for Mohol TSS of RVNL for Rail Electrification**) referred to as utility services in subsequent paras.

Whereas the Licensee has applied to the Authority for permission to lay Overhead 132KV Electrical Power Transmission Line Crossing from Km. 221/600 to 221/627

And whereas the Authority has agreed to grant such permission for way leave on the NH ROW as per terms and conditions hereinafter mentioned.

Now this agreement witness that in consideration of the conditions hereinafter contained and on the part of the Licensee to be observed and performed, the Authority hereby grants to the Licensee permission to lay utility services as per the approved drawing attached hereto subject to the following conditions, namely.

1. ROW permissions are only enabling in nature. The purpose of extending the way leave facility on the National Highway ROW is not for enhancing the scope of activity of a utility service provider, either by content or by intent. Further enforceability of the permission so granted shall be restricted only to the extent of provisions/ scope of activities defined in the license agreement & for the purpose for which it is granted.
2. No Licensee shall claim exclusive right on the ROW and subsequent user will be permitted to use the ROW, either above or below or by the side of the utilities laid by the first user, subject to technical requirements being fulfilled. Decision of the Authority in relation to fulfillment of technical requirements shall be final and binding on all concerned parties. In case any disruption/damage is caused to any existing user by the subsequent user, the Authority shall not be held accountable or liable in any manner.
3. The Licensee shall be responsible for undertaking all activities including, but not limited to site identification, survey, design, engineering, arranging finance, project management, obtaining regulatory approvals & necessary clearances, supply of equipment, material, construction, erection, testing and commissioning, maintenance and operation and all other activities essential or required for efficient functioning of their own utility/ industrial infrastructure facilities.
4. The Licensee shall pay license fee @ Rs/sq.m/month to the Authority. The license fee shall become payable from the date of handing over of ROW land to the Licensee, for laying of utilities/cables/conduits/pipelines for infrastructure/ service provider. As regards Tariff and Terms and conditions for providing common utility ducts along National Highways, there shall be a separate agreement regime.
5. Fee shall have to be paid in advance for the period for which permission is granted for entering into a license agreement. In case of renewal, rate prevailing at the time

of renewal shall be charged. Delay in deposition of fee shall attract interest @ 15% per annum compounded annually.

6. The Licensee shall make his own arrangement for crossing of cross drainage structure, rivers, etc. Below the bed. In case, this is not feasible, the utility services may be carried outside the railings/parapets and the bridge superstructure. The fixing and supporting arrangements with all details shall be required to be approved in advance from the concerned Highway Administration. Additional cost on account of fixing and supporting arrangement as assessed by the Authority shall be payable by the Licensee.
7. In exceptional cases, where ROW is restricted the utility services can be allowed beneath the carriageway of service road, if available, subject to the condition that the utility services be laid in concerned ducts, which will be designed to carry traffic on top. The width of the ducts shall not be less than one lane. In such cases, it also needs to ensure that maintenance of the utility services shall not interface with the safe and smooth flow of traffic. The cost of operation and maintenance will have to be borne by the Licensee.
8. It is to be ensured that at no time there is interference with the drainage of the road land and maintenance of the National Highways. Towards this, the top of the utility services shall be at least 0.6 meter below the ground level. However, any structure above ground shall be aesthetically provided for/ landscaped with required safety measures as directed by the concerned Authority.
9. The utility services shall be permitted to cross the National Highway either through structure or conduits specially built for that purpose. The casing/ conduit pipe should, as minimum, extend from drain to drain in cuts and toe of slope to toe of slope in the fills and shall be designed in accordance with the provision of IRC and executed following the Specifications of the Ministry
10. The utility services shall cross the National Highway preferable on a line normal to it or as nearly so as practicable.
11. All required restoration work subsequent to laying of the cable shall be required to be undertaken by the Licensee at its cost either by itself or through its authorized representative in consultation with the Authority as per predetermined time schedule and quality standards
12. Prior to commencement of any work on the ground, a performance Bank Guarantee @Rs.-----per route meter/Rs-----per sq.m with a validity of one year initially (extendable if required till satisfactory completion of work) shall have to be furnished by the Licensee to the Authority / its designated agency as a security against improper restoration of ground in terms of filling unsatisfactory compaction damages caused to other underground installations/utility services & interference, interruption, disruption or failure caused their of to any services etc In case of the Licensee failing to discharge the obligation of making good of the excavated trench/other

restoration work the Authority shall have a right to make good the damages caused by excavation, at the cost of the Licensee and recover the amount by forfeiture of the Bank Guarantee.

13. In case, the Performance Bank Guarantee is invoked as mentioned above, the Licensee shall be required to replenish and reinstate the required Performance Bank Guarantee within one month of such invoking. In case the work contemplated herein is not completed to the satisfaction of the Authority which has granted the permission, within a period of 11 months from the date of issue the Bank Guarantee, the Licensee shall either furnish a fresh guarantee or extend the guarantee for a further period of one year. Notwithstanding this, the Licensee shall be liable to pay full compensation to the aggrieved Authority / its designated agency for any damage sustained by them by reason of the exercise of the Row facility.
14. The Licensee shall shift the utility services within 90 days (or as specified by the respective Authority) from the date of issue of the notice by the concerned Authority to shift/relocate the utility services, in case it is so required for the purpose of improvement/widening of the road/route/highway or construction of flyover/bridge and restore the road/land to its original condition at his own Cost and risk.
15. The Licensee shall be responsible to ascertain from the respective agency in co-ordination with Authority, regarding the location of other utilities /underground installations/ facilities etc. The Licensee shall ensure the safety and security) of already existing underground etc. before commencement of the excavation /using the existing cable ducts. The Licensee shall procure insurance from a reputed insurance company against damages to already existing underground installations /utilities/facilities etc.
16. The Licensee shall be solely responsible/ liable for full compensation /indemnification of concerned agency / aggrieved Authority for any direct, indirect or consequential damage caused to them/claims or replacements sought for, at the cost and risk of the Licensee. The concerned agency in Coordination with Authority shall also have a right make good such damage / recover the claims by forfeiture of Bank Guarantee.
17. If the Licensee fails to comply with any condition to the satisfaction of the Authority, the same shall be executed by the Authority at the cost and risk of the Licensee.
18. Grant of License is subject to the Licensee satisfying (a) minimum disruption of traffic and (b) no damage to the highways. As far as possible, the Licensee should avoid cutting of the road for crossing highway and other roads and try to carry out the work by trenchless technology. In case any damage is caused to the road pavement in this process, the Licensee will be required to restore the road to the original condition at its cost. If due to unavoidable reasons the road needs to be cut for crossing or laying utility services, the Licensee has to execute the restoration work in a time bound manner at its cost either by itself or through its authorized representative in consultation with the Authority as per predetermined time schedule

and quality standards. In case of the licensee failing to discharge the obligation of making good of the excavated trench/other restoration work, the Authority shall have a right to make good the damages caused by excavation, at the cost of the Licensee and recover the amount by forfeiture of the Bank Guarantee.

19. The Licensee shall inform/give a notice to the concerned agency designated by the Authority at least 15 day in advance with route details prior to digging trenches, for fresh or maintenance /repair works. A Separate performance Bank Guarantee for maintenance /repair works shall have to be furnished by the Licensee
20. The permission for laying utility Services Is granted maximum for 5 years at a time, which can thereafter be considered for renewal. On payment of additional fee at the time of renewal, the permission shall automatically be renewed, unless defaults exist. In case of renewal, rate prevailing at the time of renewal shall be charged. Delay in deposition of fee shall attract interest @ 15% per annum compounded annually.
21. The permission shall be valid only for the period it is issued and fee deposited. However, the Authority also has a right to terminate the permission or to extend the period of Agreement.
22. That the Licensee shall not undertake any work of shifting, repairs or alterations to the utility services without prior written permission of the concerned agency in coordination with the Authority.
23. The permission granted shall not in any way be deemed to convey to the Licensee any ownership right or any interest in route/road/highway land /property, other than what is herein expressly granted. No use of NH Row will be permitted for any purpose other than that specified in the Agreement.
24. During the subsistence of this Agreement, the utility services located in highway land / property shall be deemed to have been constructed and continued only by the consent and permission of the Authority so that the right of the Licensee to the use thereof shall not become absolute and infeasible by lapse of time.
25. The Licensee shall bear the Stamp Duty charged on this Agreement.
26. Three copies of laid drawings of utilities (hard and soft copies) with geo tagged photographs and geo tagged video recordings of laying of cables in the trench (with respect to the NH) and after complete restoration shall be submitted to the Authority for verification and record within a month of completion of works.
27. The Licensee shall allow free access to the Site at all times to the authorized representatives of Authority to inspect the Project Facilities and to investigate any matter within their authority, and upon reasonable notice, shall provide reasonable assistance necessary to carry out their respective duties and functions.

28. The utility services shall not be made operational by the licensee unless a completion certificate to the effect that the utility services has been laid in accordance with the approved specifications and drawings and the trenches have been filled up to the satisfaction of the concerned agency in coordination with the Authority has been obtained. Notwithstanding anything contained herein, this agreement may be canceled at any time by Authority for breach of any condition of the same and the licensee shall neither be entitled to any compensation for any loss caused to it by such cancellation nor shall it be absolved from any liability already incurred.
29. The licensee shall ensure adherence to relevant Indian standards and follow best industry practices, methods and standards for the purpose of ensuring the safe, efficient and economic design, construction, commissioning, operation, repair and maintenance of any part of utility lines/ industrial infrastructure facilities and which practices, methods and standards shall be adjusted as necessary, to take account of:
- a) Operation, repair and maintenance guidelines given by the manufacturer.
 - b) The requirements of law
 - c) The physical conditions at the site and
 - d) The safety of operating personnel and human beings
30. The licensee shall have to provide safety measures like barricading, danger lighting and other necessary caution boards while executing the work.
31. While laying utility services, at least one lane of road shall be kept open to traffic at all times. In case of single lane roads, a diversion shall be constructed. If any traffic diversion works are found necessary during the working period such diversion shall be provided at the cost of licensee.
32. After the termination/ expiry of the agreement, the licensee shall remove the utility services within 90 days and the site shall be brought back to original condition failing which the licensee will lose the right to remove the utility services. However before taking up the work of removal of utility services the licensee shall furnish a Bank Guarantee to the authority for a period of one year for an amount assessed by the authority as a security for making good and excavated trench by proper filling and compaction, clearing debris, loose earth produced due to excavation of trenching at least 50 meters away from the edge of the ROW.
33. Any disputes in interpretation of the terms and condition of this agreement or their implementation shall be referred to the redress mechanism prevailing in the ministry and the decision of the redress mechanism shall be final and binding on all.
34. For PPP Projects, in case of any financial loss Incurred by the respective project concessionaires due to such laying/shifting of utility services by the licensee, compensation or the same shall be required to be borne by the licensee in mutual agreement with the

respective project concessionaires. MoRT&H/ NHAI implementing authorities for the project shall not be liable to the Concessionaire in any way in this regard.

This agreement has been made in duplicate, each on a Stamp paper, each party to this Agreement has retained one stamped copy each.

IN WITNESS WHERE OF THE PARTIES HERETO HAVE CAUSED THIS AGREEMENT TO BE EXECUTED THROUGH THEIR RESPECTIVE AUTUORISED REPRESENTATIVES THE DAY AND THE YEAR FIRST ABOVE WRITTEN.

SIGNED SEALED AND DELIVERED FOR AND ON BEHALF OF AUTHORITY.

BY SHRI

(Signature, name & address with stamp)

SIGNED ON BEHALF OF MSETCL (LICENSEE)

BY SHRI S.K.Gade

Executive Engineer
EHV, Project Div. III,
M.S.E.T.Co.Ltd, Solapur.

(Signature, name & address with stamp)

HOLDER OF GENERAL POWER OF ATTORNEY DATED..... EXECUTED IN
ACCORDANCE WITH THE RESOLUTION NO..... DATED.....
PASSED BY THE BOARD OF DIRECTORS IN THE MEETING HELD ON

IN THE PRESENCE OF (WITNESSES):

Mr. S. S. Devarkonda,
Additional Executive Engineer, EHV S&I Sub Division-III,
Solapur.

Mr. S.B. Dhamure
Additional Executive Engineer, EHV Projects Division-III
Solapur.



महाराष्ट्र MAHARASHTRA

© 2019 ©

VW 558211

सोलापूर अ. क्र. ११५५५ दि. १९/१/२०२०

सौ. / श्री. भा. य. पं. भा. य. पं. महापौराध्यक्ष के. ज. प्र. वि. ३.

यांनी रुपये

चा जनरल स्टॅम्प

मागितलेवरून हा स्टॅम्प

स्टॅम्प व भारतीय रुपये

या कारणासाठी स्टॅम्प दिला.

चा
चा

Kartik Maheshwar



श्री. बलभिम रामचंद्र आयवळे

मुद्रांक विक्रेता परवाना क्र. १०९/२०००

रा. ४००/७, बेगम पेठ, सोलापूर.

पो. नं. १४२०७८०५७५ कोड नं. २५९९००४

UNDERTAKING CERTIFICATE

We, EHV, Project Division-III, MSETCL., Solapur Office at The 132 KV Navi ves S/S, Old mill compound premises, Solapur - 413006, India. Here by do undertake interference to our ROW application for overhead crossing of 132 KV TRANSMISSION LINE from km 231-600 to km 221-600, of Pune-Solapur section of NH-65, near Kolegoan, Tal- Mohol, for total span of 196 m, for Mohol Railway Traction Sub Station of Rail Vikas Nigam Ltd., in state of Maharashtra that,

1. We hereby undertake, that if any necessary alteration including complete removal shifting of the overhead Cables and Tower poles crossing on the Solapur - Pune Road NH 65 in km. 221/600 to 221/627 Village - Kolegaon, Taluka - Mohol, Dist. - Solapur if so required by Ministry for the development of National Highway of India. Interest of Safety in This Section at our own Cost.
2. We hereby also undertake to pay the necessary rent for laying of overhead cable cross the National Highway whenever the national authorities ask rents in future.
3. We hereby undertake that in respect to part -1 and 2 are shall not violate any condition and that we would not enter into any litigation in any manner.
4. We also further undertake to ensure conformity as per the norms of National Highway.
5. We have understood the complete picture of four lane project of National Highway No.65 i.e. Pune-Solapur road,
6. We understood that no laying of overhead cables or construction of tower poles shall be done till the permission is granted by the MORT & H New Delhi,
7. We declare that we will not display any advertisement / hoarding along the national highway no. 65 without prior approval of the National Highway Authority of India.
8. We hereby undertake to bear the entire cost of construction & maintenance of laying of overhead cables & tower poles and its signs as necessary and other traffic control devices at our own cost.
9. We hereby undertake to lay overhead cables including tower poles, as per the norms specified by govt. of India ministry of road transport and highway, New Delhi from time to time.
10. If in future, by any reason, any accident or death caused by 132kV overhead transmission line, then only the Maharashtra State Electricity Transmission co. Ltd will be held responsible for it and the claims will be settled by Maharashtra State Electricity Transmission co. Ltd. only. The National Highway Authority of India department will not be involved in any case so fund/claims in any. The periodical maintenance of road crossing will be the responsibility of Maharashtra State Electricity Transmission co. Ltd.
11. All legal matters in future regarding this work should be cleared by Maharashtra State Electricity Transmission Co. Ltd. Company on its own expenses and responsibility

National Highway Authority of India department will not be responsible in any way for any legal matter.

12. The rules and regulation altered or updated time to time by National Highway Authority of India department will be obligatory for this work, we will follow all the rules and regulation here in future. It is understood that the department reserves the right to alter or update any regulation time to time without informing the Maharashtra State Electricity Transmission Co. Ltd.
13. We hereby undertake all responsibilities during the laying overhead cables any damage to the road or to any other structure of the road will be made good by us at our own cost.
14. We hereby undertake the responsibility that the overhead cable will be shifted in case it is requested at a later stage at our own cost.

S. Chyande
Executive Engineer
EHV, Project Div. III,
M.S.E.T.Co.Ltd., Solapur.



महाराष्ट्र MAHARASHTRA

© 2019 ©

VX 870235

सोलापूर अ. क. ११४६५ दि. २९/११/२०१९
 सौ. / श्री. ~~नाथीकर~~ ~~श्री. वि. ना. मेटापांडे~~ भ-३-रा जंगल वि-३-कोमगाड
 यांनी स्वयं चा जनरल स्टॅम्प
 मागितलेल्या अ. क. मध्ये चा
 स्टॅम्प व नोंदणीकृत स्वयं चा
 या कारणासाठी स्टॅम्प दिला.

श्री. बालधिम रामचंद्र आयवळे
 मुद्रांक विक्रीसाठी परवाना क्र. १०९/२०००
 रा. ४००/७, बेगम पेठ, सोलापूर.
 मो. नं. ९४२०७८०५७५ कोड नं. २५११००४

Annexure 2.2

UNDERTAKING

We, EHV, Project Division-III, MSETCL, Solapur Office at The 132 KV Navi ves S/S, Old mill compound premises, Solapur - 413006, India. Here by do undertake interference to our ROW application for overhead crossing of 132 KV TRANSMISSION LINE from km 221/600 to km 221/627, of Pune-Solapur section of NH-65, near Kolegoan, Tal- Mohol, for total span of 196 m, for Mohol Railway Traction Sub Station of Rail Vikas Nigam Ltd., in state of Maharashtra that,

1. MSETCL Shall submit performance bank guarantee for the proposed work as and when the demand note raised by NHAI.
2. MSETCL Shall renew the performance bank guarantee as and when required if work is not completed within one year of the submission of the B.G.

[Signature]
 Executive Engineer
 EHV, Project Div. III,
 M.S.E.T.Co.Ltd., Solapur.



महाराष्ट्र MAHARASHTRA

2019

VX 870270

सोलापूर अ. क्र. ११४६६ दि. २२/११/२०१९
 सौ. श्री. राजेश प्रेमराज मल्लिकार्जुन शिंदे यांना या जनरल स्टॅम्पचा क्र. ३-११ प्रत्यक्ष वि. ३ दिला.
 या जनरल स्टॅम्पचा क्र. ३-११ प्रत्यक्ष वि. ३ दिला.
 या जनरल स्टॅम्पचा क्र. ३-११ प्रत्यक्ष वि. ३ दिला.

श्री. राजेश प्रेमराज मल्लिकार्जुन शिंदे
 मुद्रांक विभाग परवाना क्र. १०९/२०००
 रा. ४००/७, वेगम पेठ, सोलापूर.
 फो. नं. ९४२०७८०५७५ कोड नं. २५९९००४

UNDERTAKING

Annexure 2.3

We, EHV, Project Division-III, MSETCL, Solapur Office at The 132 KV Navi ves S/S. Old mill compound premises, Solapur - 413006, India. Here by do undertake interference to our ROW application for overhead crossing of 132 KV TRANSMISSION LINE from km 221/600 to km 221/627, of Pune-Solapur section of NH-65, near Kolegoan, Tal- Mohol, for total span of 196 m, for Mohol Railway Traction Sub Station of Rail Vikas Nigam Ltd., in state of Maharashtra that,

We will be carrying out the overhead cable laying as per the specification and standards of NHAI and execution will confirm all the standard conditions of NHAI guidelines.

[Signature]
 Executive Engineer
 EHV, Project Div. III,
 MSETCL Ltd. Solapur



महाराष्ट्र MAHARASHTRA

© 2019 ©

सोलापूर अ.क. १४४४ दि. १४/११/२०१९

सौ. श्री. ध्यायचंद्रा धीमय्या प्रसादरेषण अ-३ ए. प्रजापति वि. ३. सोलापूर

यांनी स्वाम्ये या जमिनी स्टॅम्प

मागितले वस्तु हा स्वाम्ये

स्टॅम्प व भारतीय स्वाम्ये

या कारणासाठी स्टॅम्प दिला.

श्री. ध्यायचंद्रा धीमय्या

मुद्रांक विभाग, सोलापूर अ.क. १०९/२०००

रा. ४००/७, जेम्स रोड, सोलापूर.

पो. नं. १४२०७८०५७५ कोड नं. २५९९००४



UNDERTAKING

Annexure 2.4

We, EHV, Project Division-III, MSETCL, Solapur Office at The 132 KV Navi ves S/S, Old mill compound premises, Solapur - 413006, India. Here by do undertake interference to our ROW application for overhead crossing of 132 KV TRANSMISSION LINE from km 221/600 to km 221/627, of Pune-Solapur section of NH-65, near Kolegoan, Tal- Mohol, for total span of 196 m, for Mohol Railway Traction Sub Station of Rail Vikas Nigam Ltd., in state of Maharashtra that,

We will shift our overhead Power line at our own cost as and when required by NHAI Authority within such times as stipulated time mentioned by NHAI.

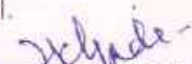
Executive Engineer
EHV, Project Div. III,
M.S.E.T.Co.Ltd., Solapur



महाराष्ट्र MAHARASHTRA

2019

साक्षात् अ. क्र. 24990008 दि. 24/11/2019
 सौ. / श्री. दायजी दासराव धर्माचार्य कृ. उ. दा. प्रमाण कि-3
 यांनी करणारे 3- या जनरल स्टॅम्प
 नागालेखन हा करणारे या स्टॅम्प व भारतीय रुपये
 या कारणासाठी स्टॅम्प दिला.

VX 870
 कोल्हापूर कार्यालय
 21 NOV 2019
 उद्दिष्ट समुदाय निमित्त

श्री. बलराम रामचंद्र आयवळे
 मुद्रांक विवेका पदाचा क्र. 909/2000
 रा. 800/8, वेगम पेठ, सोलापूर.
 पो. नं. 9820920404 जेड नं. 24990008

Annexure 2.5

UNDERTAKING

We, EHV, Project Division-III, MSETCL, Solapur Office at The 132 KV Navi ves S/S, Old mill compound premises, Solapur - 413006, India. Here by do undertake interference to our ROW application for overhead crossing of 132 KV TRANSMISSION LINE from km 221/600 to km 221/627, of Pune-Solapur section of NH-65, near Kolegoan, Tal- Mohol, for total span of 196 m, for Mohol Railway Traction Sub Station of Rail Vikas Nigam Ltd., in state of Maharashtra that,

We will relocate overhead Power line lines/ utilities at our cost, notwithstanding the permission granted with in such time as will be stipulated by NHAI for further expansion.

Executive Engineer
 EHV, Project Div. III,
 MSETCL Ltd. Solapur



महाराष्ट्र MAHARASHTRA

© 2019 ©

VX 870

सोलापूर अ. क. ११४६६ दि. २९/११/२०१९

सो. / सी. पाथेकरा धर्मेश्वर देवपरेषण दि. ३. ११. २०१९ कि. ३

धानी सादवे १- चा जनरल स्टॅम्प

मागितले वस्तु हा सधवे

स्टॅम्प व भारतीय कागद

चा

चा कारणासाठी स्टॅम्प दिला.

श्री. बलविभ रामचंद्र आनवळे

मुद्रांक विक्रेता पथकाना क्र. १०९/२०००

रा. ४००/५, धनम पेठ, सोलापूर.

मो. नं. ९४२०७८०५७५ कोड नं. २५११००४

Annexure 2.6

UNDERTAKING

We, EHV, Project Division-III, MSETCL, Solapur Office at The 132 KV Navi ves S/S, Old mill compound premises, Solapur - 413006, India. Here by do undertake interference to our ROW application for overhead crossing of 132 KV TRANSMISSION LINE from km 221/600 to km 221/627, of Pune-Solapur section of NH-65, near Kolegoan, Tal- Mohol, for total span of 196 m, for Mohol Railway Traction Sub Station of Rail Vikas Nigam Ltd., in state of Maharashtra that,

MSETCL Shall be solely responsible / liable for full compensation / indemnification to concerned agency / aggrieved owners for any or direct or consequential damages caused to them / Claim or replacement sought for at our cost and risk.

Executive Engineer
EHV, Project Div. III,
MSETCL Ltd. Solapur



महाराष्ट्र MAHARASHTRA

2019

सोलापूर अ. क्र. ११४७२ द. २६/११/२०१९

सौ. / श्री. वलभिम रामचंद्र आयवळे यांना या करणासाठी स्टॅम्प दिला.

यांनी रुपये १००, या जनरल स्टॅम्प

प्राप्तिले. या करणे

स्टॅम्प व भरलेले रुपये

या कारणासाठी स्टॅम्प दिला.

श्री. वलभिम रामचंद्र आयवळे

मुद्रांक विक्रेता परवाना क्र. १०९/२०००

रा. ४००/७, वेगम पेठ, सोलापूर.

पो. नं. ९४२०७२०५७५ कोड नं. २५११००४



Annexure 2.9

UNDERTAKING

We, EHV, Project Division-III, MSETCL, Solapur Office at The 132 KV Navi ves 5/S, Old mill compound premises, Solapur - 413006, India. Here by do undertake interference to our ROW application for overhead crossing of 132 KV TRANSMISSION LINE from km 221/600 to km 221/627, of Pune-Solapur section of NH-65, near Kolegoan, Tal- Mohol, for total span of 196 m, for Mohol Railway Traction Sub Station of Rail Vikas Nigam Ltd., in state of Maharashtra that,

The prior approval of NHA shall be obtained before undertaking any work of installation, shifting or repairs, or alteration to the showing overhead power lines located in the ROW of National Highway- 65 of above said line.

Executive Engineer
EHV, Project Div. III,
M.S.E.T.Co.Ltd. Solapur



महाराष्ट्र MAHARASHTRA

● 2019 ●

VX 870 000

सोलापूर अ. क्र. २९४०९ दि. २६/११/२०१८

श्री. वलभिम रामचंद्र आयवळे यांना सोलापूर येथे ३-रा. प्रकल्प कि. ३- सोलापूर

पाणी संपादन

मागिल संदर्भात या संपादना

स्टॅम्प व भारतीय न्यायिक

या कारणासाठी स्टॅम्प दिला.

श्री. वलभिम रामचंद्र आयवळे

मुद्रांक विक्रेता परवाना क्र. १०९/२०००

रा. ४००/७, वेगम पेठ, सोलापूर.

पो. नं. ९४२०७८०५७५ कोड नं. २५९९००४

Annexure 2.10

UNDERTAKING

We, EHV, Project Division-III, MSETCL, Solapur Office at The 132 KV Navi ves S/S, Old mill compound premises, Solapur - 413006, India. Here by do undertake interference to our ROW application for overhead crossing of 132 KV TRANSMISSION LINE from km 221/600 to km 221/627, of Pune-Solapur section of NH-65, near Kolegoan, Tal- Mohol, for total span of 196 m, for Mohol Railway Traction Sub Station of Rail Vikas Nigam Ltd., in state of Maharashtra that,

Expenditure, if any incurred by NHAI for repairing any damages caused to the National Highway by the laying, maintenance or shifting or the overhead power line will be borne by MSETCL.

Executive Engineer
EHV, Project Div. III,
M.S.E.T.Co.Ltd., Solapur.



महाराष्ट्र MAHARASHTRA

2019

VX 870298

सोलापूर अ. क्र. १४६४ दि. २९/११/२०१९
 सौ. / श्री. महेशचंद्र रामचंद्र आयबळे यांना १०० रु.चा जन्मदिवस स्टॅम्प
 यांनी १०० रु.चा जन्मदिवस स्टॅम्प
 यांनी १०० रु.चा जन्मदिवस स्टॅम्प
 स्टॅम्प व भरतीची कागद
 या कः रणासाठी स्टॅम्प दिला.

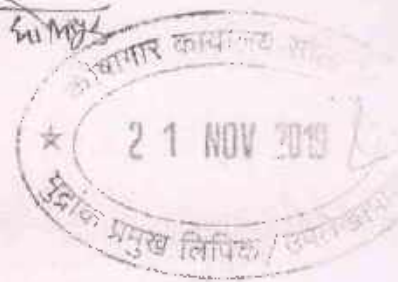

श्री. महेशचंद्र रामचंद्र आयबळे
 मुद्रांक विभागात भरविला क्र. १०९/२०००
 रा. ४००/७, वेणुग पेठ, सोलापूर.
 मो. नं. ९४२०७८०५७५ कोड नं. २५९९००४

Annexure 2.11

UNDERTAKING

We, EHV, Project Division-III, MSETCL, Solapur Office at The 132 KV Navis S/S, Old mill compound premises, Solapur - 413006, India. Here by do undertake interference to our ROW application for overhead crossing of 132 KV TRANSMISSION LINE from km 221/600 to km 221/627, of Pune-Solapur section of NH-65, near Kolegoan, Tal- Mohol, for total span of 196 m, for Mohol Railway Traction Sub Station of Rail Vikas Nigam Ltd., in state of Maharashtra that,

If, NHAI is considered it necessary in future to remove the overhead Power line for any work of improvement or repair to the road, it will be carried out as desired by NHAI at the cost of MSETCL (Owing the Overhead power line) within stipulated reasonable time (Not Exceeding 60 days) of the intimation given.

Executive Engineer
 EHV, Project Div. III,
 M.S.E.T.Co.Ltd. Solapur



महाराष्ट्र MAHARASHTRA

2019

VW 558207

सोलापूर अ. क्र. 93471 दि. 1/1/2020

सौ./श्री. व्यासधरि भगवता महाशय क. ग. रत्नकर सि-3

वांनी रुपये १- या जनसुख स्टेम

मागितलेवरून हा रुपये - या

स्टेम व भारतीय रुपये या

या कारणासाठी स्टेम दिला.

Handwritten signature

श्री. बलभिम रामचंद्र आयवळे

मुद्रांक विक्रेता परवाना क्र. 909/2000

रा. 400/9, बेगम पेठ, सोलापूर.

पो. नं. 9420660464 कोड नं. 2499004

Handwritten signature: Kartik Maheshwar



UNDERTAKING

Annexure 2.14

We, EHV, Project Division-III, MSETCL, Solapur Office at The 132 KV Navi ves S/S, Old mill compound premises, Solapur - 413006, India. Here by do undertake interference to our ROW application for overhead crossing of 132 KV TRANSMISSION LINE from km 221/600 to km 221/627, of Pune-Solapur section of NH-65, near Kolegoan, Tal- Mohol, for total span of 196 m., for Mohol Railway Traction Sub Station of Rail Vikas Nigam Ltd., in state of Maharashtra that,

The MSETCL ensures the safety of the highway traffic against the hazard of the high voltage lines during installation, operations and maintenance.

Handwritten signature
Executive Engineer
EHV, Project Div. III,
MSETCL, Solapur



महाराष्ट्र MAHARASHTRA

© 2019 ©

VW 558208

सोलापूर अ. क्र. 9377 दि. ११/१/२०२०
सौ. / श्री. धनंजय रामचंद्र आर्य या जनरल स्टॅम्प
गोनी रुपये हा स्टॅम्प व भारतीय रुपये
या कारणासाठी स्टॅम्प दिला.



श्री. बलभिम रामचंद्र आर्यवले
मुद्रांक विक्रेता परवाना क्र. १०९/२०००
रा. ४००/७, वेगम पॅठ, सोलापूर.
मो. मं. ९४२०७८०५७५ कोड नं. २५९९००४

Annexure 2.15

UNDERTAKING

We, EHV, Project Division-III, MSETCL, Solapur Office at The 132 KV Navi ves S/S, Old mill compound premises, Solapur - 413006, India. Here by do undertake interference to our ROW application for overhead crossing of 132 KV TRANSMISSION LINE from km 221/600 to km 221/627, of Pune-Solapur section of NH-65, near Kolegoan, Tal- Mohol, for total span of 196 m, for Mohol Railway Traction Sub Station of Rail Vikas Nigam Ltd., in state of Maharashtra that,

We compliance with Indian Electricity rules and other authorities regulations all overhead lines shall comply with the requirement of the Indian Electricity act and rules made their under and-regulation or specification laid down by NHA.

Signature
Executive Engineer
EHV, Project Div. III,
M.S.E.T.Co.Ltd., Solapur.

INSPECTION REPORT

The Proposal for obtaining the road crossing of 132 KV Mohol TSS line of M/s. Maharashtra State Electricity Transmission Co. Ltd. at Km 221/600 to 221/627 of Pune- Solapur section of NH-65 nearby Mohol Taluka.

The site has been inspected on the Day _____ and the actual site inspection report is as under.

1) Height of the bottom most conductor above road ____ Meters.

2) Right side tower is at 119 Meter from road center & left side tower is at 77 Meter from road center.

Inspection done by:-

1)

2)

**NATION HIGHWAY AUTHORITY OF INDIA. LTD Construction of NH-65 Solapur to Pune National Highway PROPOSAL FOR
CROSSING OF 132 KV Mohol TSS TRANSMISSION LINE
Near Kolegoan (Mohol)-Village Kolegoan**

Sr no	Details of NH-65 Crossing	
1	Crossing Tower no . Type & Angle } (i)	LOC no . 9 & Loc no 10
	(ii)	S + 9 & S + 6 Respectively
	(ii)	Tower Designed up to 60°
2	Ground Elevation (LOC 9 & LOC 10)	Mentioned on profile
3	Crossing Distance NH-65 to LOC 9 and LOC 10	Centre of NH-65 TO LOC No 9 = 119 Mtrs
		Centre of NH-65 TO LOC No 10 = 77 Mtrs
4	Crossing distance NH-65	196 Mtrs
5	Way leave clearance	115 Mtrs & 33 Mtrs
6	Ground clearance + Sag error	14.42 Mtrs as per Drawing enclosed
7	Crossing span required	196 Mtrs (15-250)
8	Crossing span Available	196 Mtrs
9 GPS CO-ordinate of LOC 9 & LOC 10		(1) UTM Co-ordinate 572261.470/ 1967298.720 Easting / Northing
		(II) UTM Co-ordinate 572282.576/ 1967493.153 Easting / Northing
10	Tower Height LOC 9 & LOC 10	LOC No : 09 = 37.577 Mtrs & LOC No : 10 = 34.577 Mtrs

 Executive Engineer
 EHV, Project Div. III,
 M.S.E.T.Co.Ltd., Solapur.

महाराष्ट्र शासन

क्रमांक: पावामा-२०१८/प्र.क्र.३९२/ऊर्जा-४

उद्योग, ऊर्जा व कामगार विभाग,
मादाम कामा रोड, हुतात्मा राजगुरु चौक,
मंत्रालय, मुंबई-३२

दूरध्वनी क्र. ०२२-२२८८३४१५

दिनांक:- २८ जानेवारी, २०१८

विषय : महापारेषण कंपनीशी संबंधित असलेल्या पारेषण नवीन पारेषण वाहिन्या उभारण्यासाठी विद्युत अधिनियम, २००३ च्या कलम ६८ अन्वये शासनाची पूर्व परवानगी देणेबाबत.

संदर्भ : संचालक (संचलन) महापारेषण कंपनी, यांचे पत्र क्र. मराविपाकम / सांका / पा.प्र/ १०२४, दि. १८.०८.२०१८

आदेश

मला उपरोक्त विषयाशी संबंधित महापारेषण कंपनीच्या संदर्भीय पत्राच्या अनुषंगाने, असे कळविण्याचे आदेश आहेत की, महापारेषण कंपनीने मंजूर केलेल्या व सोबतच्या परिशिष्टातील (परिशिष्ट अ,ब,क) विवरण पत्रात नमूद केलेल्या योजना अंतर्गत पारेषण वाहिन्या उभारण्यासाठी व उभारून ठेवण्यासाठी विद्युत कायदा, २००३ च्या कलम ६८ अन्वये पुढे नमूद केलेल्या अटीच्या अधिन राहून शासन मान्यता देण्यात येत आहे.

१. सदरहू वीज वाहिन्यांची उभारणी कंपनी स्वखर्चाने विहित केलेल्या प्रमाणित पद्धतीने आणि तज्ञांच्या मार्गदर्शनाखाली व पर्यवेक्षणाखाली करेल.
२. सदरहू वीज वाहिन्यांचे संचलन व सुव्यवस्था कंपनी स्वतः करेल.
३. सदरच्या वीज वाहिन्यांचा वापर कंपनीने ज्या प्रयोजनार्थ करावयाच्या ठरविला आहे केवळ त्याचा प्रयोजनासाठी करणे कंपनीवर बंधनकारक असेल.
४. सदरहू वीज वाहिन्या कार्यान्वित करण्यापूर्वी / प्रभारीत करण्यापूर्वी याबाबतच्या सक्षम प्राधिकार्याकडून (यथास्थिती मुख्य विद्युत निरीक्षक / विद्युत निरीक्षक) पूर्व परवानगी घेणे आवश्यक असेल.
५. सदरहू वीज वाहिन्या उभारल्यानंतर संबंधित शेतकऱ्यांच्या/ संबंधित जागा मालकाच्या जर काही तक्रारी असल्यास सक्षम प्राधिकार्यासमवेत विचारविनिमय करून त्या तक्रारीचे यथायोग्यरित्या निराकरण करणे, ही जबाबदारी सर्वस्वी कंपनीची असेल.
६. सदरहू वीज वाहिन्या उभारणे व उभारून ठेवणे या अनुषंगाने आवश्यक असलेले सर्व परवाने मिळवणे, विहित केलेल्या निकषांची पूर्तता करणे तसेच शासनाचे विविध प्राधिकरणे / विभाग / वीज नियामक आयोग इ. चे इतर प्रचलित नियम त्याचप्रमाणे शासनाने वेळोवेळी मंजूर केलेले नियम व अटी कंपनीवर बंधनकारक राहतील.

७. विद्युत अधिनियम २००३ व सदर अधिनियमाच्या कलम ६८ मधील अटी व शर्ती व त्यात वेळोवेळी होणारे बदल, उद्योग, ऊर्जा व कामगार विभागाने निर्गमित केलेला शासन निर्णय क्रमांक : धोरण-२०१६/प्र.क्र.५२०/ऊर्जा-४, दिनांक ३१.०५.२०१७ मधील अटी व शर्ती तसेच राज्य शासन व केंद्र शासनाची अति उच्चदाब पारेषण वाहिनीसंबंधीची वेळोवेळी जाहीर झालेली / होणारी मार्गदर्शक तत्त्वे व धोरणे सदरहू पारेषण वाहिनीस लागू होतील.

८. सदरहू परवान्याचा कालावधी परवानापत्र दिल्यापासून २५ वर्षांचा असेल, तदनंतर सदरहू परवानगी आपोआप संपुष्टात येईल.

हे आदेश महाराष्ट्र शासनाच्या www.maharashtra.gov.in या संकेतस्थळावर उपलब्ध करण्यात आला असून त्याचा संकेतांक २०१९०१२८१६४६२८९०१० असा आहे. हा आदेश डिजिटल स्वाक्षरीने साक्षात्कृत करून काढण्यात येत आहे.

महाराष्ट्राचे राज्यपाल यांच्या आदेशानुसार व नावाने,

BHIMASHANKAR
YALLAPPA MANTA

Digitally signed by BHIMASHANKAR
YALLAPPA MANTA
DN: CN = BHIMASHANKAR YALLAPPA
MANTA, O = Maharashtra, D =
GOVERNMENT OF MAHARASHTRA, OU =
ENERGY DEPARTMENT
Date: 2019.01.28 18:42:05+05'30'

(भि.य. मंता)

उप सचिव, महाराष्ट्र शासन

प्रति,

व्यवस्थापकीय संचालक,

महाराष्ट्र राज्य विद्युत पारेषण कंपनी मर्या.

प्रकाशगंगा, वांद्रे-कुर्ला संकुल, वांद्रे (पुर्व)

मुंबई - ४०० ०५१

प्रत,

संचालक (प्रकल्प), महाराष्ट्र राज्य विद्युत पारेषण कंपनी मर्या., प्रकाशगंगा, वांद्रे-कुर्ला संकुल, वांद्रे (पुर्व), मुंबई - ४०० ०५१

परिशिष्ट - क

महापारेषण कंपनीने समर्पित वितरण सुविधा (डी.डी.एफ.) अंतर्गत मंजूर केलेले प्रकल्प

अ.क्र.	योजनेचा तपशील	योजनेअंतर्गत असलेल्या वाहिन्यांचा तपशील	मान्यता क्र. व दि.
१	रायगड जिल्ह्यातील करंजाडे येथे डि.डि. एफ. योजने अंतर्गत मे. भारतीय रेल्वेच्या मध्य रेल्वे (डि एफ सी सी आय एल) रेल्वे कर्षण उपकेंद्राकरिता २२० के.व्ही. क्षमतेवर पुरवठा करणे.	(i) २२० के.व्ही. ओ.एन.जी.सी. ते पनवेल कर्षण उपकेंद्रावरील वाहिनीवर मनोरा क्र.२ व ३ पासून प्रस्तावित २२० के.व्ही. करंजाडे रेल्वे कर्षण उपकेंद्रापर्यंत मोनोपोलद्वारे लिलो वाहिनी उभारणे - २ कि.मी.	CMD/MSFT CL/ १२२७.दि. २९.११.२०१७
२	धुळे जिल्ह्यातील बोरविहिर येथे डि.डि. एफ. योजने अंतर्गत मे. भारतीय रेल्वेच्या मध्य रेल्वे कर्षण उपकेंद्राकरिता १३२ के.व्ही. क्षमतेवर पुरवठा करणे.	(i) १३२ के.व्ही. धुळे- चाळीसगाव एकपथ वाहिनीवर मनोरा क्र. १३५ पासून प्रस्तावित बोरविहिर कर्षण उपकेंद्रापर्यंत लिलो वाहिनी उभारणे- ३ कि.मी.	MSETCL/DI r(O)/ १९७३.दि. ०५.१२.२०१७
३	नागपूर जिल्ह्यातील पाटणसावंगी येथे डि.डि. एफ. योजने अंतर्गत मे. भारतीय रेल्वेच्या मध्य रेल्वे कर्षण उपकेंद्राकरिता १३२ के.व्ही. क्षमतेवर पुरवठा करणे.	(i) १३२ के.व्ही. कळमेश्वर-सावनेर वाहिनीवर १३२ के.व्ही. पाटणसावंगी कर्षण उपकेंद्रापर्यंत लिलो वाहिनी उभारणे- ३.६ कि.मी.	MSETCL/DI r(O)/ १९५९.दि. ०६.१२.२०१७
४	पारेवाडी येथे डि.डि. एफ. योजने अंतर्गत मे. भारतीय रेल्वेच्या मध्य रेल्वे कर्षण उपकेंद्राकरिता १३२ के.व्ही. क्षमतेवर पुरवठा करणे.	(i) अस्तित्वात असलेल्या १३२ के.व्ही. परेवाडी ते प्रस्तावित १३२ के.व्ही. परेवाडी कर्षण उपकेंद्रापर्यंत द्विपथ वाहिनी उभारणे - २ कि.मी.	CMD/MSFT CL/ १२४२.दि. ०८.१२.२०१७
५	सोलापूर जिल्ह्यातील मोहोळ येथे डि.डि. एफ. योजने अंतर्गत मे. भारतीय रेल्वेच्या मध्य रेल्वे कर्षण उपकेंद्राकरिता १३२ के.व्ही. क्षमतेवर पुरवठा करणे.	(i) १३२ के.व्ही. चिंचोळीकाटी ते मोहोळ उपकेंद्र वाहिनी च्या मनोरा क्र. ८१ पासून प्रस्तावित १३२ के.व्ही. मोहोळ कर्षण उपकेंद्रापर्यंत द्विपथ लिलो वाहिनी उभारणे - ४.५ कि.मी.	CMD/MSET CL/ १२७०.दि. ०८.१२.२०१७
६	पालघर जिल्ह्यातील सफाळे येथे डि.डि. एफ. योजने अंतर्गत मे. भारतीय रेल्वेच्या मध्य रेल्वे कर्षण उपकेंद्राकरिता २२० के.व्ही. क्षमतेवर पुरवठा करणे.	(i) २२० के.व्ही. वसई/नालासोपारा-बोईसर पी.जी. एकपथ वाहिनीवर प्रस्तावित सफाळे कर्षण उपकेंद्रासाठी २२० के.व्ही. लिलो वाहिनी उभारणे- १ कि.मी.	CMD/MSFT CL/ १३४१.दि. २८.०२.२०१७



LOC NO. 9 (S+9)
WITH INDEPENDENT EARTHING

107.55

22.87

65.58

LOC NO. 10 (S+6)

LEVEL (M)	CHAINAGE(M)
485.748	0
485.883	23
485.261	24
485.261	27
485.988	28
486.074	30
486.138	80
486.913	90
486.094	108
486.621	117
486.621	120
486.621	121
486.009	130
485.424	139
485.313	150
485.304	172
483.884	174
483.884	177
484.721	180
484.170	196

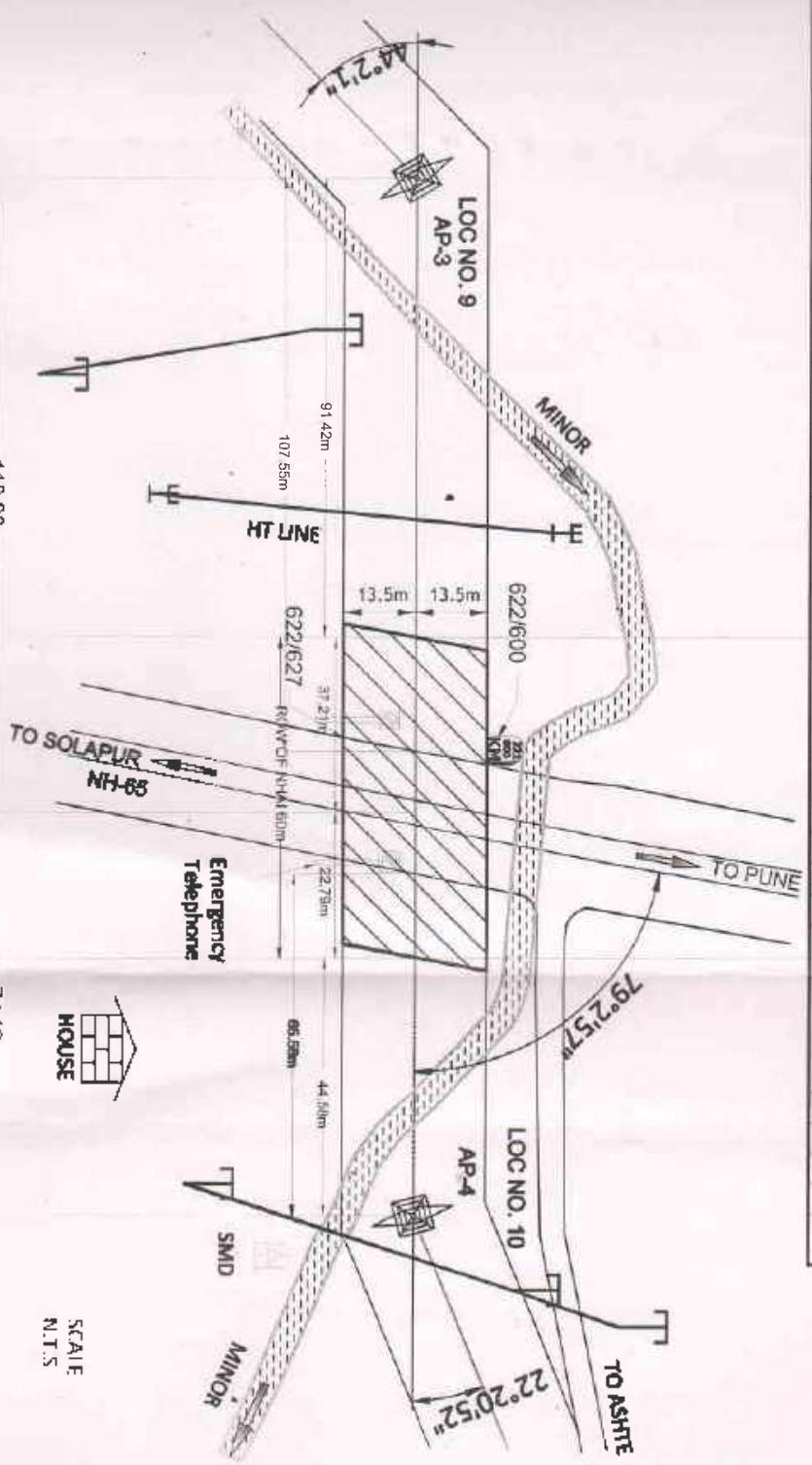

SCALE
N.T.S

PLAN

PRODUCED BY AN AUTODESK EDUCATIONAL PRODUCT

MAHARASHTRA STATE ELBC
TRANSMISSION CO. LTD.

EHV PROJECTS DIVISION, SOLAPUR

S&I SUB

PROP. 132 KV L/O ON MOHOL-CHINCH
LINE TO PROPOSED MOHOL TSS OF RV
PUNE-SOLAPUR OVER HEAD CROSSING
N.H 65 HIGHWAY

Asst Engineer (CIVIL)
S&I Sub Division
Solapur

Asst. Ex. E
S&I Sub
Solapur

Add. Ex. Engineer
EHV Project DN.
Solapur

Ex. Engineer
EHV Project DN.
Solapur

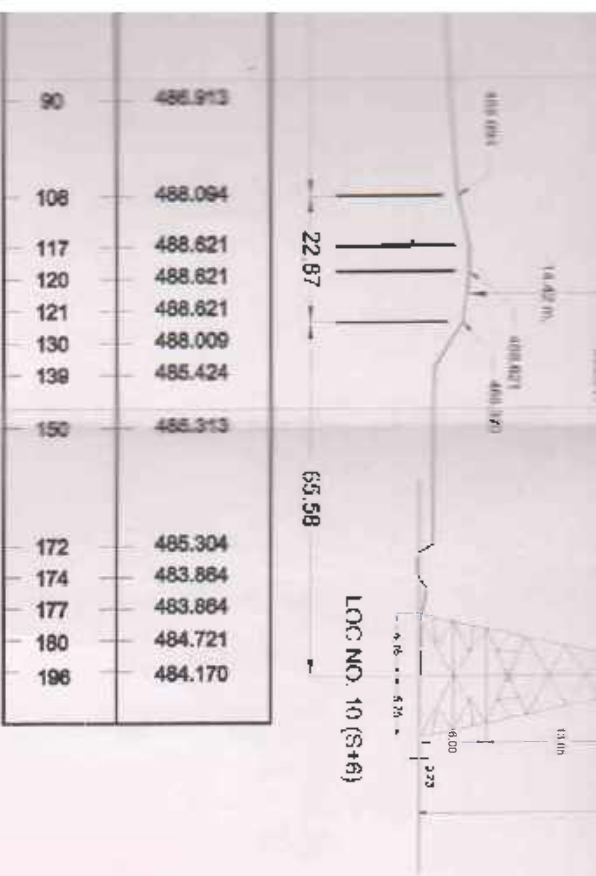

90	488.913
108	488.094
117	488.621
120	488.621
121	488.621
130	488.009
139	485.424
150	485.313
172	485.304
174	483.884
177	483.884
180	484.721
196	484.170

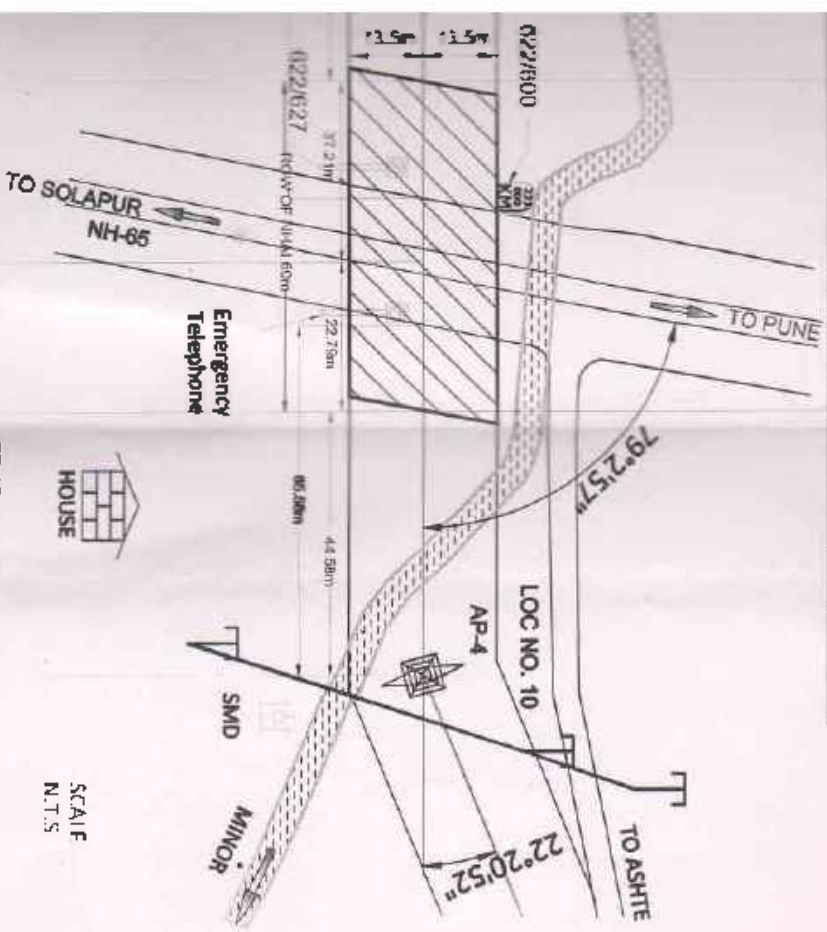

MAHARASHTRA STATE ELECTRICITY
TRANSMISSION CO. LTD.

KEY PROJECTS IN SOLAPUR

S&I SUB IN SOLAPUR

PROP. 132 KV L.I.D. ON MOHOL-CHINCHOLI (MIDC)
LINE TO PROPOSED MOHOL ISS OF RVNL ON
PUNE-SOLAPUR OVER HEAD CROSSING OF
NH 65 HIGHWAY

V. K. Mahabaleswari
Asst. Engineer (Civil)
S&I Sub Division
Solapur

Prakash
Addl. Ex. Engineer (Civil)
S&I Sub Division
Solapur

Shree
Addl. Ex. Engineer
EHV, Project DN.
Solapur

Shree
Ex. Engineer
EHV, Project DN.
Solapur

SCALE - MTS

ELEVATION

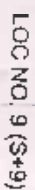
LOC NO. 10 (S+B)