

Government of India

Ministry of Road Transport & Highways

(Office of the Chief Engineer cum Regional officer, Patna)

Vill.- Chakmusa, Near Nakati Bhawani Mandir on NH-98

Post.- Mohammadpur Kurji via Khagaul, Patna-801105, Bihar

Dated-17.12.2019

Invitation of public comments

Sub: Proposal for permission for National Highway crossing at Ch. 226.04 (Bariahi- Supaul) on NH-327E by LILO (LOOP IN) Transmission Line of 400 KV D/C (Quad-Moose) Kishanganj- Patna Line at saharsa S/S under TBCB.

Sir,

Powergrid Mithilanchal Transmiwsion Ltd. has submitted the subject proposal for National Highway crossing at Ch. 226.04 (Bariahi- Supaul) on NH-327E by LILO (LOOP IN) Transmission line of 400 KV D/C (Quad-Moose) Kishanganj- Patna Line at Saharsa S/S under TBCB through CE NH, wing (North) letter no.25/Vividh-01-10/2019-1986 (Anu) dated 19.11.2019 to this office.

2. In this regard, objection of the public if any on grounds of public inconvenience, safety and general public interest, are invited on the subject proposal and hard copy of the same should reach to below mentioned address within 30 days from the day of uploading, beyond which no objection will be considered.

Address:-

The CE-Regional Office,
Ministry of Road Transport & Highways,
(Office of the Chief Engineer cum Regional officer, Patna)
Vill-Chakmusa, Near Nakati Bhawani mandir on NH-98
Post- Mohammadpur Kurji Via Khagaul, Patna- 801105, Bihar

Yours Faithfully,

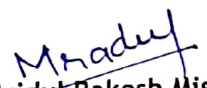
(Mridul Rakesh Mishra)
Assistant Executive Engineer,
For CE-Regional officer,
Patna.

Copy to:-

1. Senior Technical Director, NIC, Transport Bhawan, New Delhi-110001.- For uploading on Ministry's website.
2. Powergrid Mithilanchal Transmiwsion Ltd Rajeshwar Mishra, Ward No.-10, Anurag Gali, Gandhi Path Near Surya Hospital, Saharsa, Bihar- 852201.
3. EE, NH Division, Madhepura

पावरग्रिड मिथिलांचल ट्रांसमिशन लिमिटेड POWERGRID MITHILANCHAL TRANSMISSION LIMITED



पावर ग्रिड कॉर्पोरेशन ऑफ इंडिया लिमिटेड (भारत सरकार का उद्यम) की एक शत प्रतिशत स्वामित्व कम्पनी
100% Wholly Owned Subsidiary Company of Power Grid Corporation of India Limited (A Government of India Enterprise)

पू०क्षेत्रा०प्र०-I, 400/220/132 के० वी० सहरसा उप-केन्द्र : H/o राजेश्वर मिश्रा, वार्ड नं.-10, अनुराग गली, गाँधी पथ
सूर्या हॉस्पिटल के सामने, सहरसा, बिहार-852 201, दूरभाष : 06478-224043
ERTS-I, 400/220/132 KV Saharsa Sub-Station : H/o Rajeshwar Mishra, Ward No.-10, Anurag Gali, Gandhi Path
Near Surya Hospital, Saharsa, Bihar-852 201, Phone : 06478-224043

Ref. No. : ER - I/ TBCB/ SHS/ NH/ 583

Date: 07.09.2019

To,

The Superintending Engineer,
National Highway Circle,
Purnea, Bihar

Subject: Resubmission of proposals for issuance of NOC for National Highway Crossing of NH 327E (BARIYAH - SUPAUL) by LILO (LOOP OUT & LOOP IN) Transmission Line of 400 KV D/C (Quad-Moose) Kishanganj - Patna Line at Saharsa S/S under TBCB.

Ref.: Our Letter No. ER-I/ TBCB/ SHS/ NH/ 268 & 269 dated 15.03.2019

Dear Sir,

This is to inform you that following proposals were submitted to your office for National Highway Crossing of NH 327E (BARIYAH - SUPAUL) by LILO (LOOP OUT & LOOP IN) Transmission Line of 400 KV D/C (Quad-Moose) Kishanganj - Patna Line at Saharsa S/S under TBCB vide our letter under Ref. (i).

S. No.	Name of Transmission Line/ Section	Crossing Location	Chainage KM	POWERGRID Line's Xing Angle Points
(a)	LOOP IN Line of LILO of 400 KV D/C (Quad Moose) Kishanganj - Patna Line	NH - 327E near Bangaon Village	226.04 KM	AP33/0 (DD+3) to AP34/0 (DD+9)
(b)	LOOP OUT Line of LILO of 400 KV D/C (Quad Moose) Kishanganj - Patna Line	NH - 327E near Bangaon Village	225.59 KM	AP07/0 (DD+3) to AP08/0 (DD+3)

The above two proposals were returned by Chief Engineer - Regional Officer, Patna to Chief Engineer, NH (North) Wing, RCD, Bihar, Patna - 800001 vide letter dated 11.07.19 for compliance of some observations. Subsequently copy of this letter forwarded to you from Chief Engineer, RCD vide Memo No. NH-25/Civdh-01-10/ 2019/ 1495 dated 08.08.19 for necessary action.

In response to above, after discussion with you, we have complied all the observations mentioned in the letter of CE, RO, MORTH, Patna dated 11.07.2019.

We are resubmitting the above two proposals in hard copy (in 4 Sets each) with proper compliance for issuance of NOC for crossing of NH 327E by 400 KV Power Line. Online applications for both crossings have been submitted through www.morthnoc.nic.in (copy attached with proposals).

Therefore, it is requested to kindly issue the NOC of the said crossings at the earliest.

Encl.: Two nos. proposals (In 4 sets each)

Yours faithfully

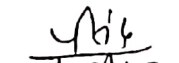
07/09/19
(P. K. Singh)

General Manager, Saharsa

CHEK LIST

1. National Highway Number : NH – 327E
2. Name of Crossing : BARIAHI – SUPAUL
3. Crossing at Chainage : 226.04 Km.
4. Position of towers : Outside the boundary of NH
5. Crossing Span : 236 M
6. Clearance over the road level : 22.00 M
7. Angle of road crossing : 78°-00'-00"
8. Distance from NH Boundary to center of tower : Loc. No.33/0 (DD+3) = 55.70 M.
Loc. No.34/0 (DD+9) = 152.20 M
9. Perpendicular distance from center of tower to center of road : Loc. No. 33/0 (DD+3) = 70.00 M
Loc. No. 34/0 (DD+9) = 166.00 M
10. Protection of assembly to the line : Anti Climbing devices & danger plate are provided
11. No. of stay required : No stay required
12. Minimum Factor of Safety : 2.0 (Normal condition)
13. Size of power conductor mm. : ACSR 'MOOSE' Conductor - Dia. – 31.77mm,
(Al. - 54/3.53mm, Steel- 7/3.53mm).
14. Size of Earth Wire : 7/3.66 mm. (Galvanized Steel)

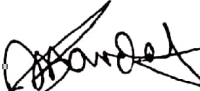
06/09/19
Santosh Kumar Mandal
Superintendent-Survey
Tata Projects Ltd.

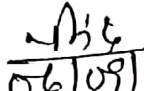

06/09/19
RAJEEV RANJAN
(RCM)
TATA PROJECTS LIMITED

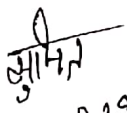
06/09/19
पी. के. सिंह / P.K. SINGH
महाप्रबंधक / GEN. MANAGER
पावरग्रिड / POWERGRID
सहरसा / SAHARSA

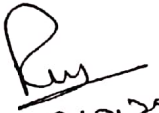
06.09.19
Sumit Kr. Prasad
सुमित कुमार प्रसाद
Chief Manager (मुख्य प्रो)
TBCB Saharsa
टी बी सी बी सहरसा

15.10.2019
A.E
N.H. Madhepur

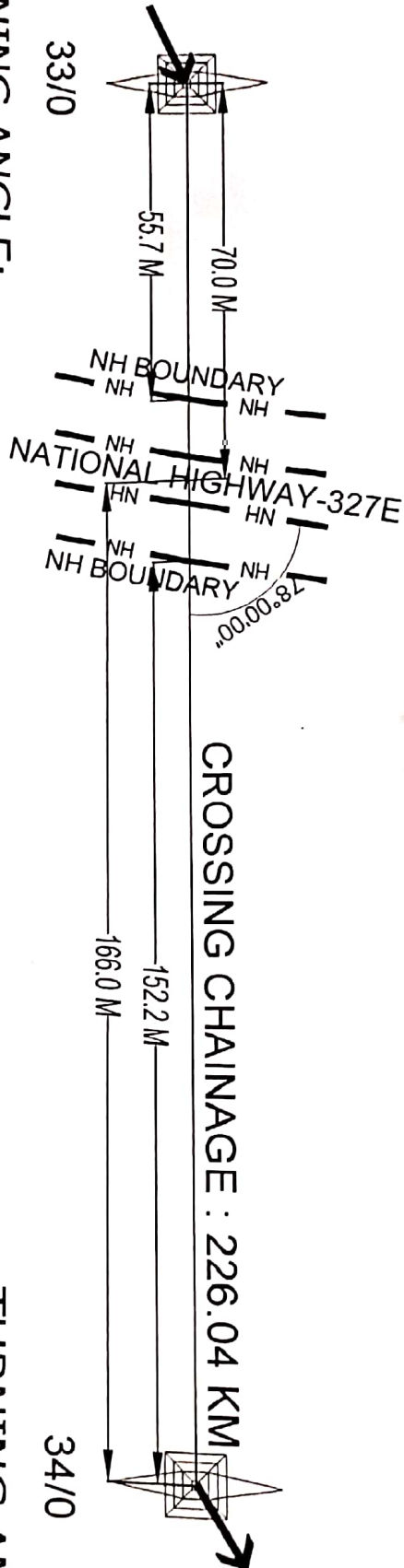
15/10/2019
Executive Engineer
N H Division Madhepura



TURNING ANGLE:
 $8^{\circ}43'41''\text{RT}$
 N-2860901
 E-452802
 NEAR BANGAON VILLAGE

TURNING ANGLE:
 $8^{\circ}15'36''\text{LT}$
 N-2861126
 E-452857
 NEAR BANGAON VILLAGE

[Signature]
 06/09/19
 Santosh Kumar Mandal
 Superintendent-Survey
 Tata Projects Ltd.

[Signature]
 06/09/19
 Sumit Kr. Prasad
 Chief Manager (मुख्य प्रसाद)
 TBCB Saharsa
 न. बी सी सी सहरसा

[Signature]
 15.10.2019
 पी. के. सिंह/P.K. SINGH
 महाप्रबंधक/GEN. MGR
 पारसगढ़/PO: ESRGRI
 सहरसा/SAHARSA